

SECTION BETWEEN CONSTRUCTION JOINTS

RC WALL / DECK INTERFACE  
ADPRUFE - INTEGRITANK SYSTEM

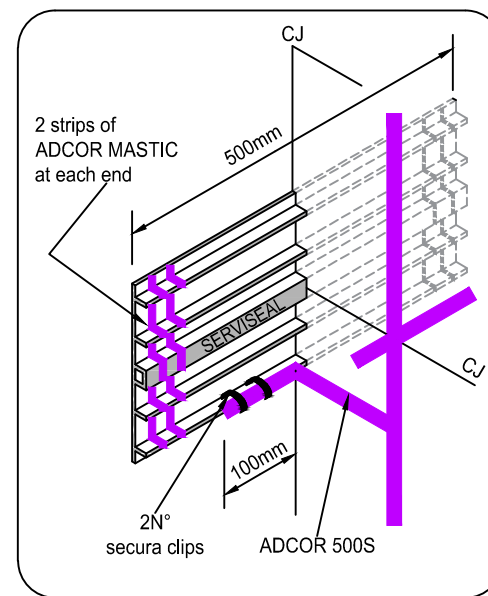

DETAIL B

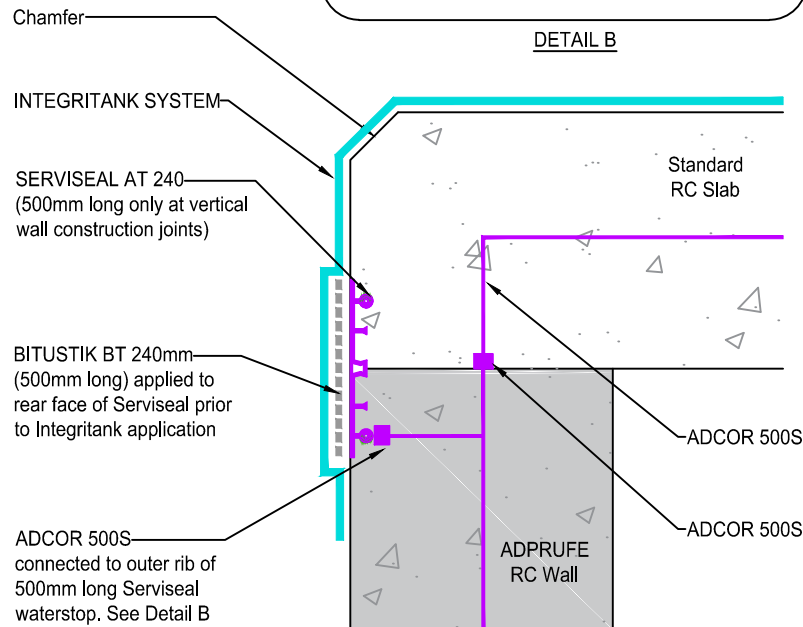

SECTION AT CONSTRUCTION JOINTS

**General Notes & Guidance:**

General Waterproofing

All waterproofing details shown herein should be brought to the attention of the designer of the structure, who is responsible for the waterproofing and structural design and for being aware of all the factors in the structural design that may impact on the waterproofing details, and approved by them in writing. Final decisions and any recommendations must be approved by the designer.

Roof Slabs / Podium Decks

This detail is for typical roof waterproofing applications only and may require modification to suit specific project conditions and design requirements. The design and application is to comply with the recommendations of BS 6229:2003 'Flat Roofs With Continuously Supported Coverings'.

Basements / Buried Decks

BS 8102:2009

6.2.4 The need for continuity in the waterproofing protection should also be considered when selecting a type of protection. In most circumstances, the protection should be continuous.

For product installation this drawing is to be read in conjunction with all relevant product data sheets.

**Drawing Notes:**

Adprufe Design Criteria

Concrete structures must be designed in accordance with BS EN 1992-1-1, BS EN 1992-1-2, BS EN 1992-3 and BS 8102, or a comparable code. Concrete containing Adprufe should be designed in accordance with the requirements of BS EN 1992-1-1 having a maximum crack width of 0.3mm; water retaining structures should be designed in accordance with BS EN 1992-3 having a maximum crack width of 0.2 mm, when the hydrostatic Pressure/wall thickness is  $\leq 5$ .

Unless noted otherwise Adprufe concrete minimum thickness to be 200mm

Rev	Date	Description

Additional Info:

Date:	Scale @ A4: NTS	Drawn:	Checked:
Project Ref:	Drawing No: INT-19-14	Rev:	



**GCP APPLIED TECHNOLOGIES**

580 / 581 Ipswich Road, Slough, Berkshire, SL1 4EQ, UK  
T: +44 (0) 1753 490000 E: info-gb@gcpat.com W: www.gcpat.com

ADCOR, ADPRUFE, AEROFIL, ARMOURTAPE, AQUATEK, BETEC, BENTORUB, BITUSHIELD, BITUSTIK, BITUTHENE, COLFLEX, DECSEAL, ELIMINATOR, GRACE ICE & WATER SHIELD, HYDRODUCT, INTEGRITANK, METASET, MS FIXER, OMNITEK, PAK ADHESIVE, PARASEAL, PERMA-BARRIER, PERMARE, PREPRUFE, PREPRUFE PLUS, PVC EDGETIE, RE-INJECTO, SAFETRACK, SENTINEL, SERVIOEK, SERVIPAK, SERVIRUFE, SERWISEAL, SERVITAPE, SERVITITE, SILCOR, SLIPSTRIP, SOLARSHIELD, VERTISEAL, ZIPLAP and GCP APPLIED TECHNOLOGIES are trademarks which may be registered in the United States and/ or other countries, of GCP Applied Technologies Inc. This trademark list has been compiled using available published information as of the publication date and may not accurately reflect current trademark ownership or status. These products may be covered by patents or patents pending.

This drawing is Copyright 2019 of GCP Applied Technologies. Permission for copying is granted only to employees, authorised representatives, customers, and specifiers to support the sale or use of GCP Applied Technologies products. All other rights are reserved.

Project:	
Client:	
Title:	<b>RC WALL / DECK INTERFACE (ADPRUFE) INTEGRITANK SYSTEM</b>