

PILE CAP - FULLY TANKED ①

- (A) Temporary formwork
- (B) Permanent formwork

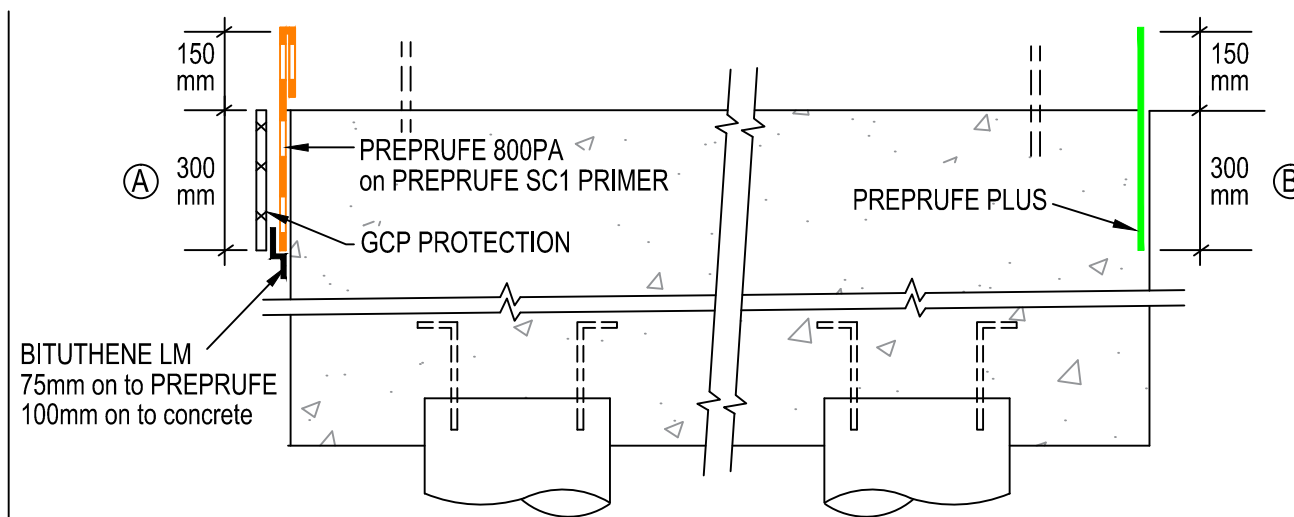

MONOLITHIC PILE CAP - DISCONTINUOUS WATERPROOFING ①
APPLICABLE ONLY TO PILECAPS OVER 600MM DEEP

- (A) Temporary formwork
- (B) Permanent formwork

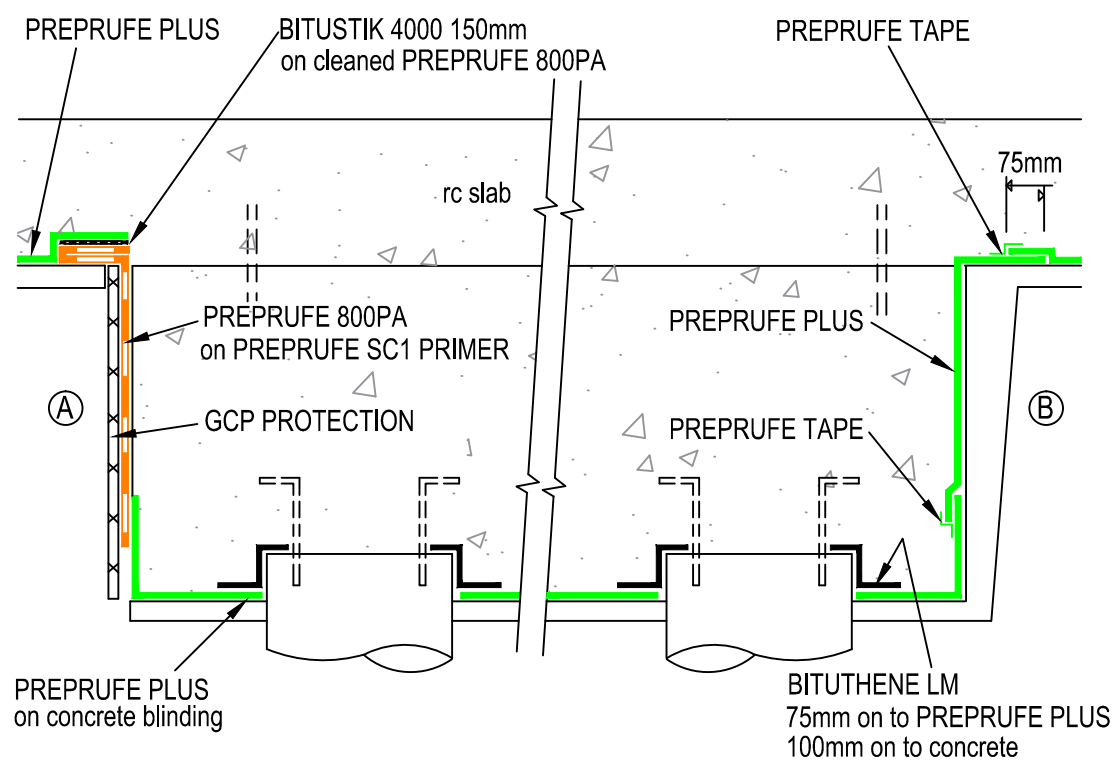

PILE CAP - FULLY TANKED ②

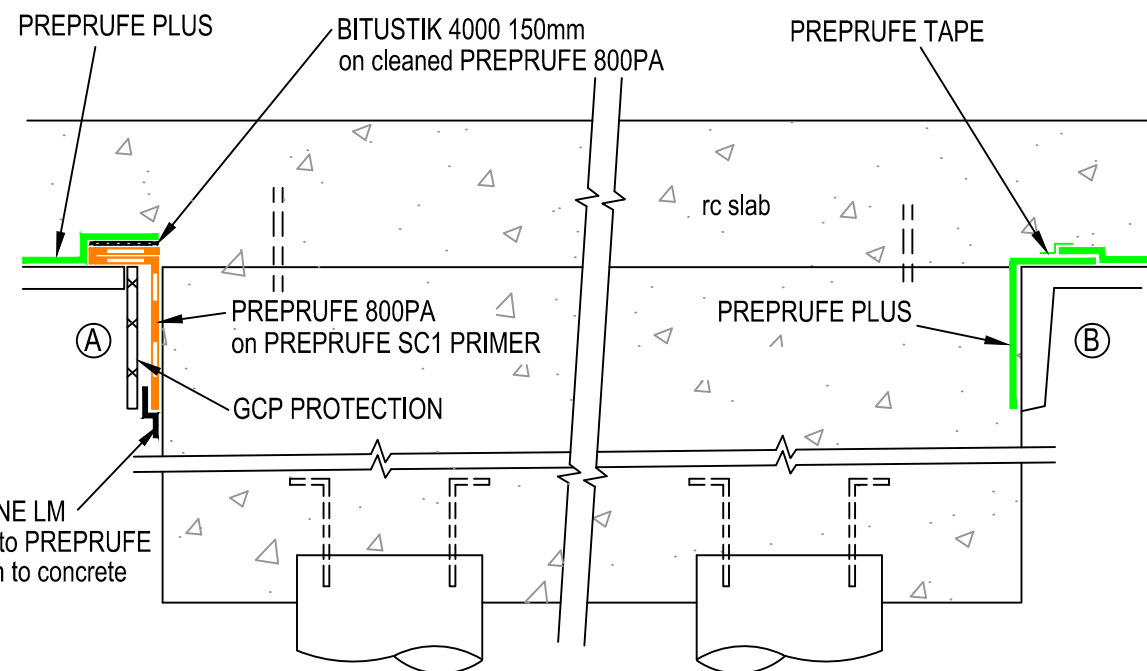

MONOLITHIC PILE CAP - DISCONTINUOUS WATERPROOFING ②
APPLICABLE ONLY TO PILECAPS OVER 600MM DEEP

Notes.

All waterproofing details shown herein should be brought to the attention of the designer of the structure, who is responsible for the waterproofing and structural design and for being aware of all the factors in the structural design that may impact on the waterproofing details, and approved by them in writing. Final decisions and any recommendations must be approved by the designer

BS8102:2009

6.2.4 The need for continuity in the waterproofing protection should also be considered when selecting a type of protection. In most circumstances, the protection should be continuous.

For product installation this drawing is to be read in conjunction with all relevant product data sheets.

Successful partial external waterproofing of the pilecap is dependent on the waterproofing integrity of the structure below the level of external waterproofing.

The designer or person responsible for the waterproofing should satisfy themselves that water cannot enter the protected structure by bypassing the detailed GCP system.

Adcor, Adprufe, Aerofil, BETEC, Bentorub, Bituthene, Hydroduct, Paraseal, Perm-A-Barrier, Preprufe, Preprufe Plus, Servidek, Servijoint, Servipak, Servirufe, Serviseal, Servitite, Silcor, Solarshield and Vertiseal are registered trademarks of GCP Applied Technologies. Armourtape, Bitushield, Bitustik, Colflex, Pak Adhesive, PVC Edgetie, Servitape, Slipstrip and Preprufe ZipLap are trademarks of GCP Applied Technologies. This drawing is Copyright 2016 of GCP Applied Technologies. Permission for copying is granted only to employees, authorised representatives, customers, and specifiers to support the sale or use of GCP Applied Technologies products. All other rights are reserved.



GCP APPLIED TECHNOLOGIES
 580/581 Ipswich Road, Slough, Berkshire, SL1 4EQ, UK
 T: +44(0)1753 490000 E: uksales@gcpat.com W: www.gcpat.com

Project:

Client:

Title:

Rev: Date: Description:

Scale: NTS

Project No:

Date:

Drawn:

Drawing No.:

Checked:

PP15-0516.dwg
 PP15-0516.rvt