

**ALTERNATIVE PREPRUFE PLUS CONFIGURATION  
HORIZONTAL TO VERTICAL**

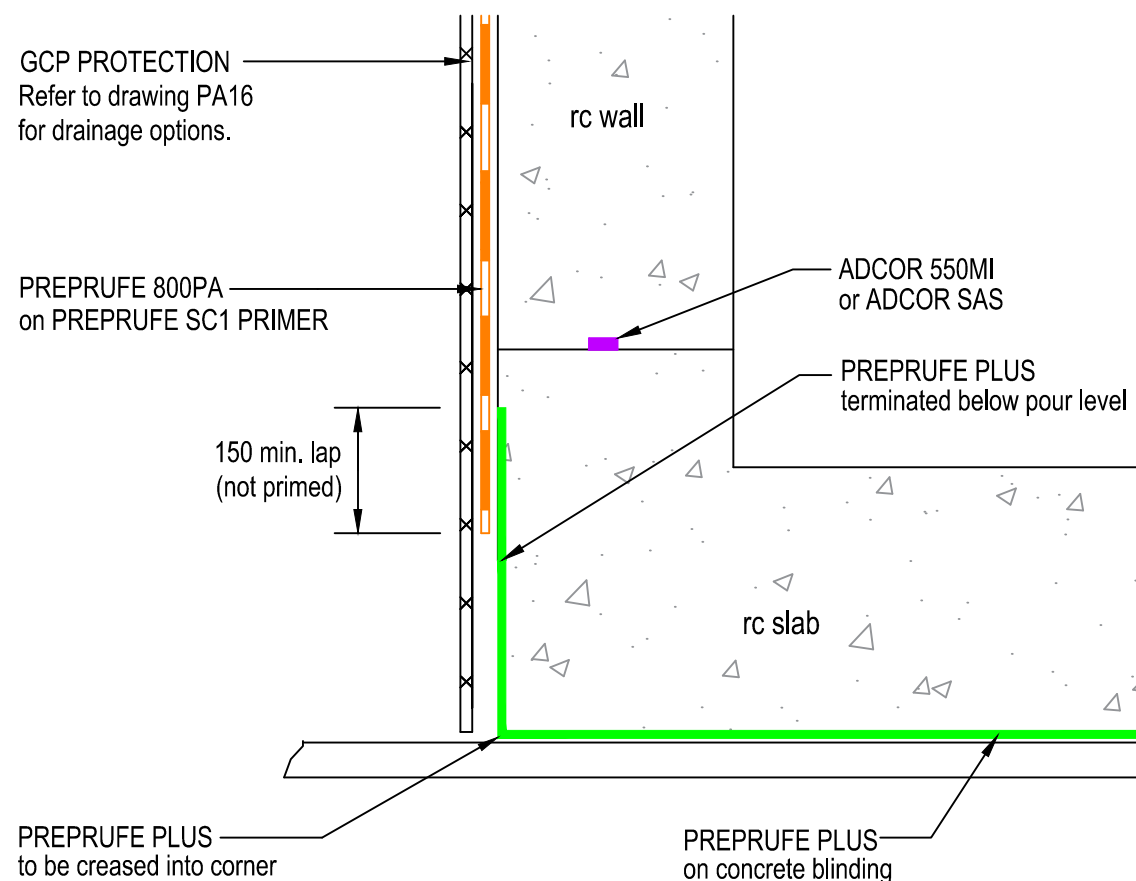

**RC WALL BASE DETAIL - REMOVABLE FORMWORK  
SECTION**

**Notes.**

All waterproofing details shown herein should be brought to the attention of the designer of the structure, who is responsible for the waterproofing and structural design and for being aware of all the factors in the structural design that may impact on the waterproofing details, and approved by them in writing. Final decisions and any recommendations must be approved by the designer

BS8102:2009

6.2.4 The need for continuity in the waterproofing protection should also be considered when selecting a type of protection.

In most circumstances, the protection should be continuous.

For product installation this drawing is to be read in conjunction with all relevant product data sheets.

Adcor, Adprufe, Aerofil, BETEC, Bentorub, Bituthene, Hydroduct, Paraseal, Perm-A-Barrier, Preprufe, Preprufe Plus, Servidek, Servijoint, Servipak, Servirufe, Serviseal, Servitite, Silcor, Solarshield and Vertiseal are registered trademarks of GCP Applied Technologies. Armourtape, Bitushield, Bitustik, Colflex, Pak Adhesive, PVC Edgetie, Servitape, Slipstrip and Preprufe ZipLap are trademarks of GCP Applied Technologies. This drawing is Copyright 2016 of GCP Applied Technologies. Permission for copying is granted only to employees, authorised representatives, customers, and specifiers to support the sale or use of GCP Applied Technologies products. All other rights are reserved.



**GCP APPLIED TECHNOLOGIES**  
580/581 Ipswich Road, Slough, Berkshire, SL1 4EQ, UK  
T: +44(0)1753 490000 E: uksales@gcpat.com W: www.gcpat.com

Project:

Client:

Title:

Rev:	Date:	Description:
------	-------	--------------

Scale: NTS

Project No:

Date:

Drawn:

Drawing No.:

Checked:

PA05-0516.dwg  
PA05-0516.rvt