

PIPE THROUGH RC SLAB - SECTION

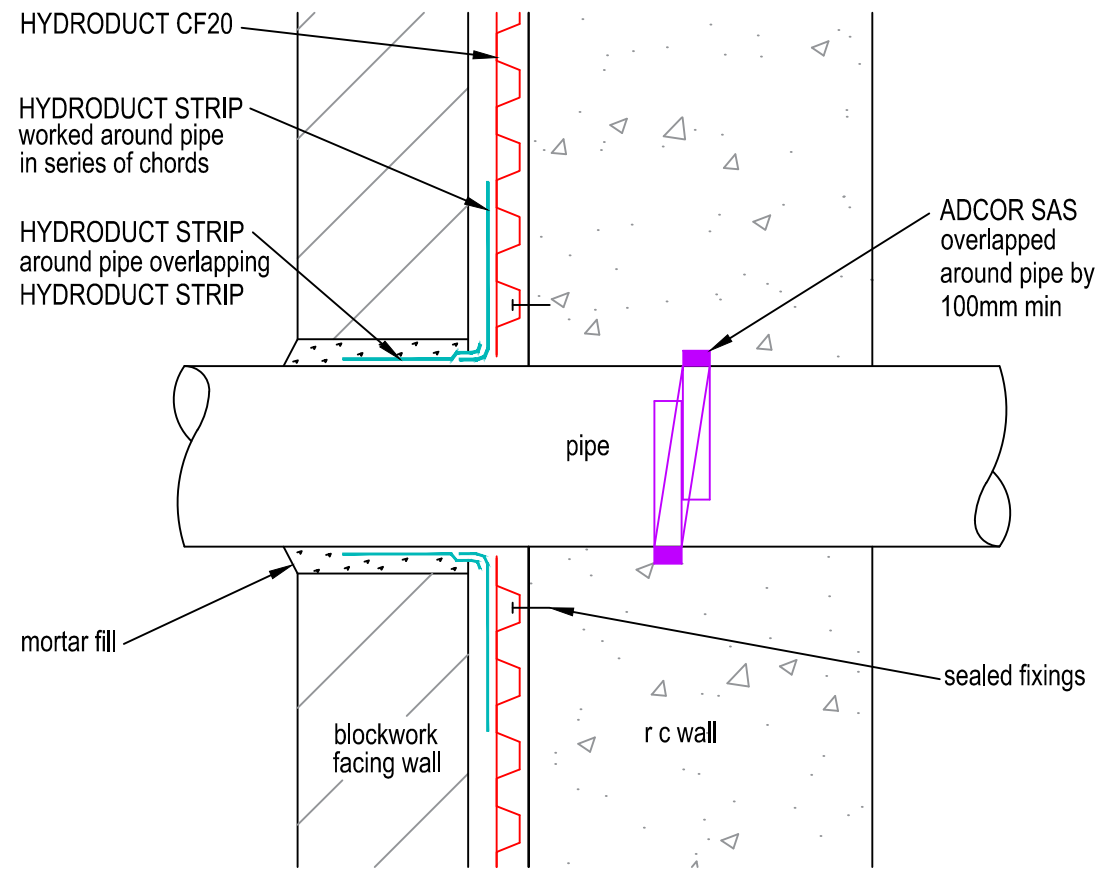

PIPE THROUGH RC WALL - SECTION / PLAN

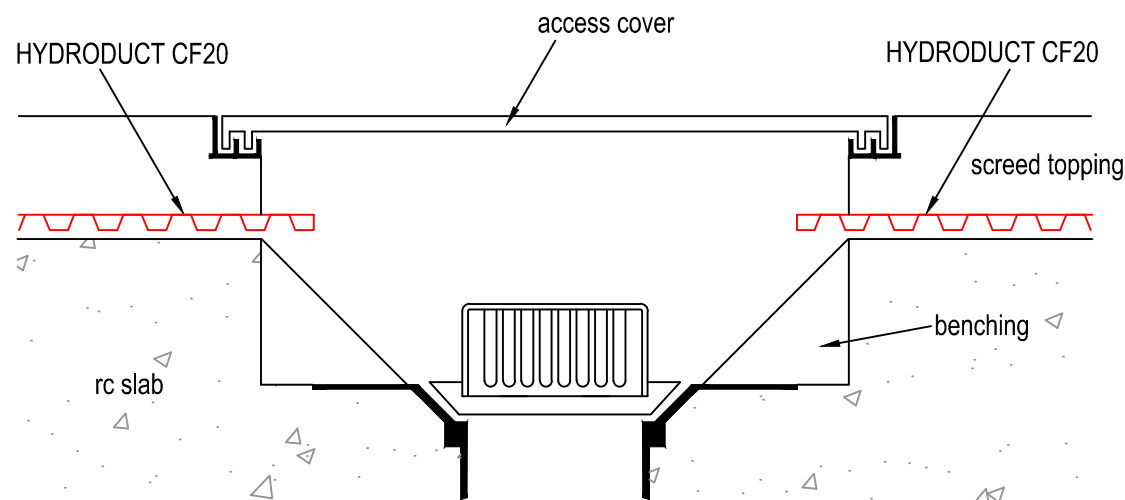

SLAB DRAINAGE DETAIL - SECTION

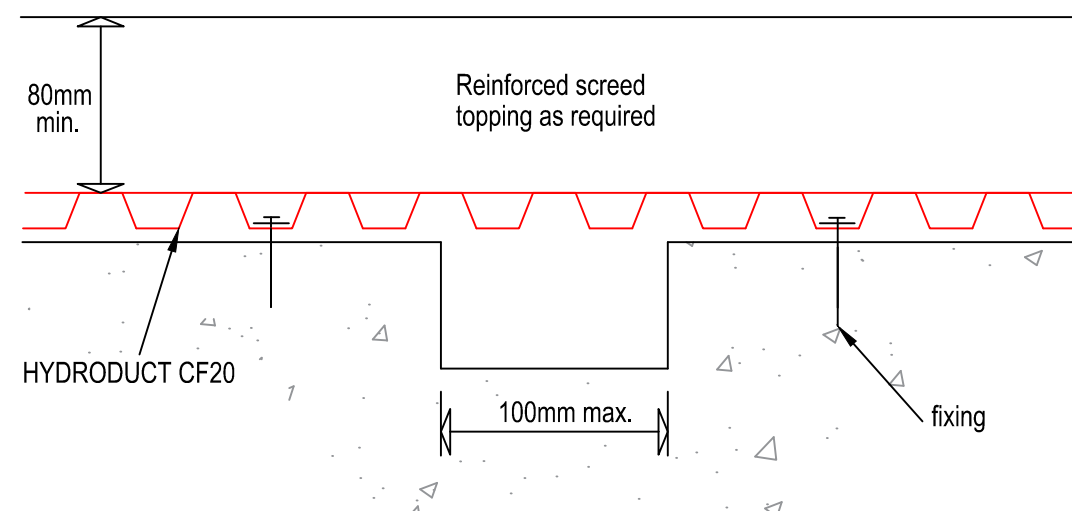

DRAINAGE CHANNEL - SECTION

Notes.

All waterproofing details shown herein should be brought to the attention of the designer of the structure, who is responsible for the waterproofing and structural design and for being aware of all the factors in the structural design that may impact on the waterproofing details, and approved by them in writing. Final decisions and any recommendations must be approved by the designer

BS8102:2009

6.2.4 The need for continuity in the waterproofing protection should also be considered when selecting a type of protection. In most circumstances, the protection should be continuous.

For product installation this drawing is to be read in conjunction with all relevant product data sheets.

BS8102:2009

10.1 The outer leaf of the exterior wall should be capable of controlling the quantity of water that can pass through it, in order not to exceed the drainage capacity of the system. Water entering a drained cavity system is regulated by the structure, so defects that might result in unacceptable leaks should be remedied before the system is installed.

All Hydroduct fixings to be corrosion resistant with self-sealing washers or post applied mastic or Servitape 50 patch.

Adcor, Adprufe, Aerofil, BETEC, Bentorub, Bituthene, Hydroduct, Paraseal, Perm-A-Barrier, Preprufe, Preprufe Plus, Servidek, Servijoint, Servipak, Servirufe, Serviseal, Servitite, Silcor, Solarshield and Vertiseal are registered trademarks of GCP Applied Technologies. Armourtape, Bitushield, Bitustik, Colflex, Pak Adhesive, PVC Edgetie, Servitape, Slipstrip and Preprufe ZipLap are trademarks of GCP Applied Technologies. This drawing is Copyright 2016 of GCP Applied Technologies. Permission for copying is granted only to employees, authorised representatives, customers, and specifiers to support the sale or use of GCP Applied Technologies products. All other rights are reserved.



Project:

Client:

Title:

Rev: Date: Description:

Scale: NTS

Date:

Drawn:

Checked:

Project No:

Drawing No.:

HD03-0516.dwg
HD03-0516.rvt