

WATERSTOP JUNCTION

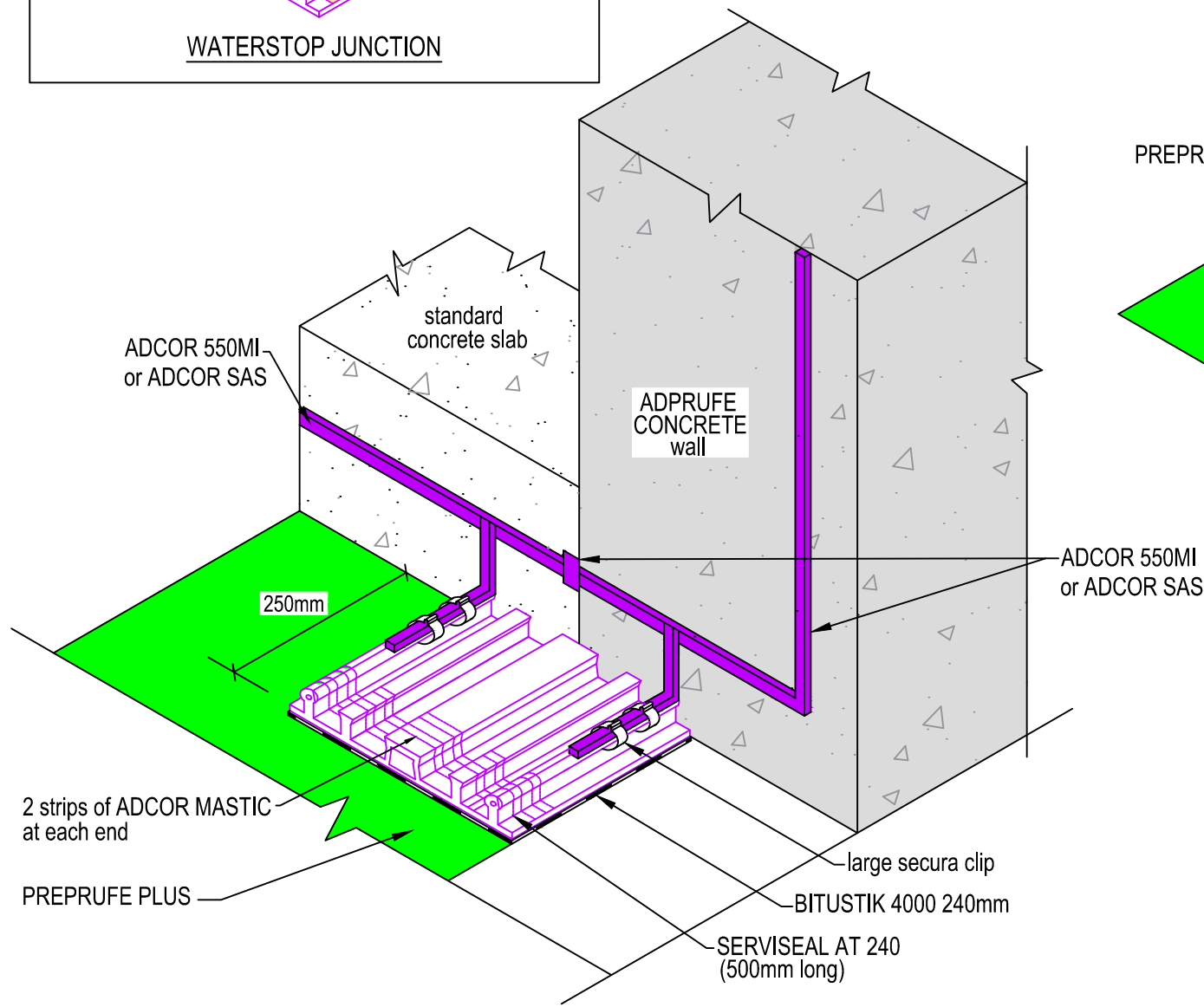

**ADPRUFE / PREPRUFE PLUS INTERFACE DETAIL
AT CONSTRUCTION JOINT**

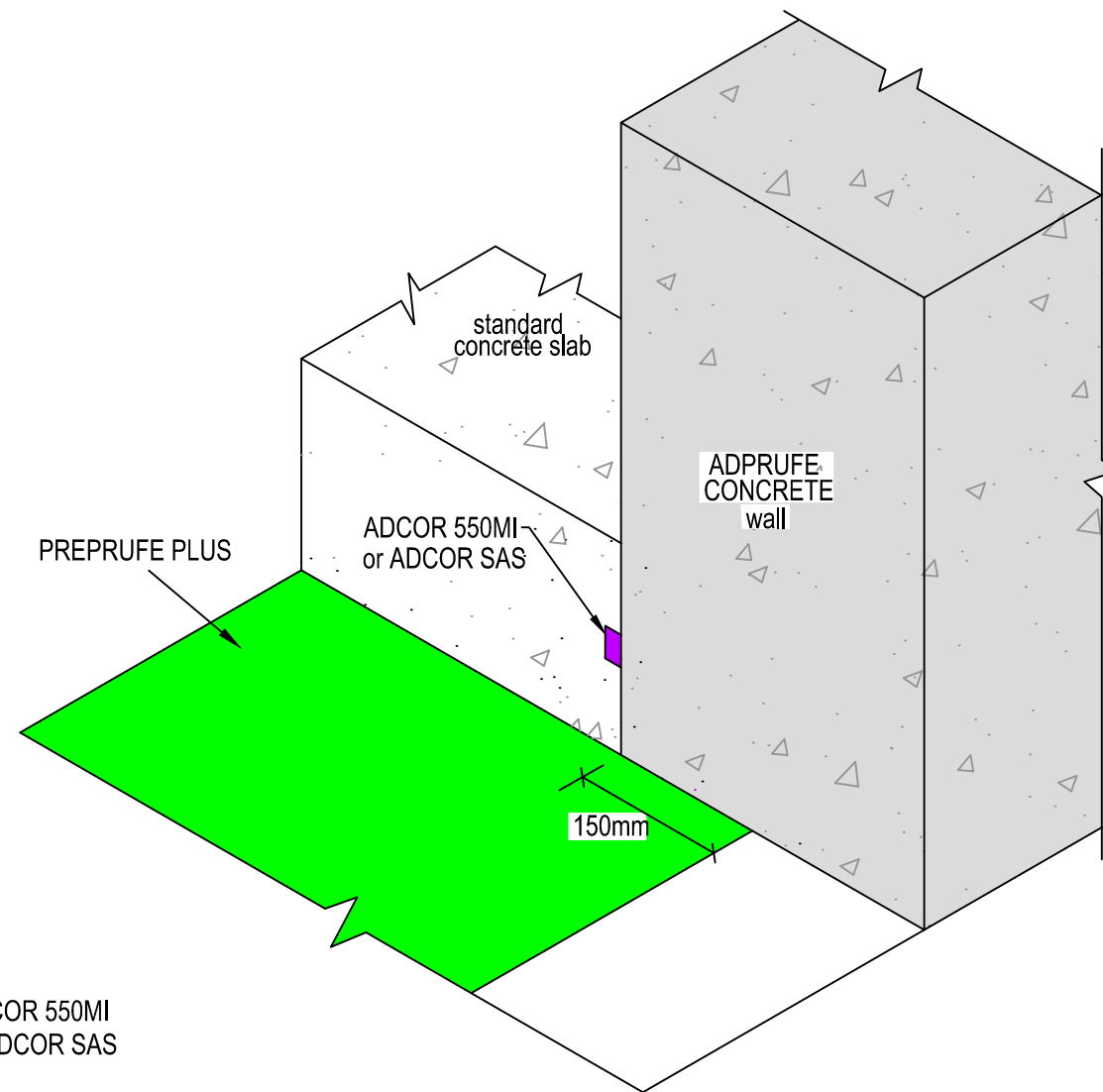

**ADPRUFE / PREPRUFE PLUS INTERFACE DETAIL
BETWEEN CONSTRUCTION JOINT**

Notes.

All waterproofing details shown herein should be brought to the attention of the designer of the structure, who is responsible for the waterproofing and structural design and for being aware of all the factors in the structural design that may impact on the waterproofing details, and approved by them in writing. Final decisions and any recommendations must be approved by the designer

BS8102:2009

6.2.4 The need for continuity in the waterproofing protection should also be considered when selecting a type of protection. In most circumstances, the protection should be continuous.

For product installation this drawing is to be read in conjunction with all relevant product data sheets.

Adprufe Design Criteria

Concrete structures must be designed in accordance with BS EN 1992-1-1, BS EN 1992-1-2, BS EN 1992-3 and BS 8102, or a comparable code. Concrete containing Adprufe should be designed in accordance with the requirements of BS EN 1992-1-1 having a maximum crack width of 0.3mm; water retaining structures should be designed in accordance with BS EN 1992-3 having a maximum crack width of 0.2 mm, when the hydrostatic Pressure/wall thickness is ≤ 5 .

Adcor, Adprufe, Aerofil, BETEC, Bentorub, Bituthene, Hydroduct, Paraseal, Perm-A-Barrier, Preprufe, Preprufe Plus, Servidek, Servijoint, Servipak, Servirufe, Serviseal, Servitite, Silcor, Solarshield and Vertiseal are registered trademarks of GCP Applied Technologies. Armourtape, Bitushield, Bitustik, Colflex, Pak Adhesive, PVC Edgetie, Servitape, Slipstrip and Preprufe ZipLap are trademarks of GCP Applied Technologies. This drawing is Copyright 2016 of GCP Applied Technologies. Permission for copying is granted only to employees, authorised representatives, customers, and specifiers to support the sale or use of GCP Applied Technologies products. All other rights are reserved.



GRACE CONSTRUCTION & PACKAGING

GCP APPLIED TECHNOLOGIES

580/581 Ipswich Road, Slough, Berkshire, SL1 4EQ, UK
T: +44(0)1753 490000 E: uksales@gcpat.com W: www.gcpat.com

Project:

Client:

Title:

Rev: Date: Description:

Scale: NTS

Project No:

Date:

Drawn:

Drawing No.:

Checked:

AD11-0516.dwg